



104-116 REGENT ST STUDENT ACCOMODATION PROJECT

Community Notification

Hi Neighbours,

Please be aware that on Thursday and Friday 20-21/07/2023 we will be completing our Hoarding Install works along Regent St during our DA hours of 7:30AM-5:30PM. During this time the footpath directly in front of site (94-116 Regent St) will be closed. Pedestrians will either need to walk on the opposite side of the road along Regent St, or detour via Margaret St, Gibbons St and Marion St.

The relevant permits and council approvals have been obtained by the necessary authorities regarding the above.

This temporary footpath closure will be between DA hours on the 20th and 21st of July 2023.

RCC appreciates your assistance during these above-mentioned works.

If there are any issues, please feel free to contact me.

Regards,

Sam Noyes - Project Manager

0466 557 620

RICHARD CROOKES CONSTRUCTIONS

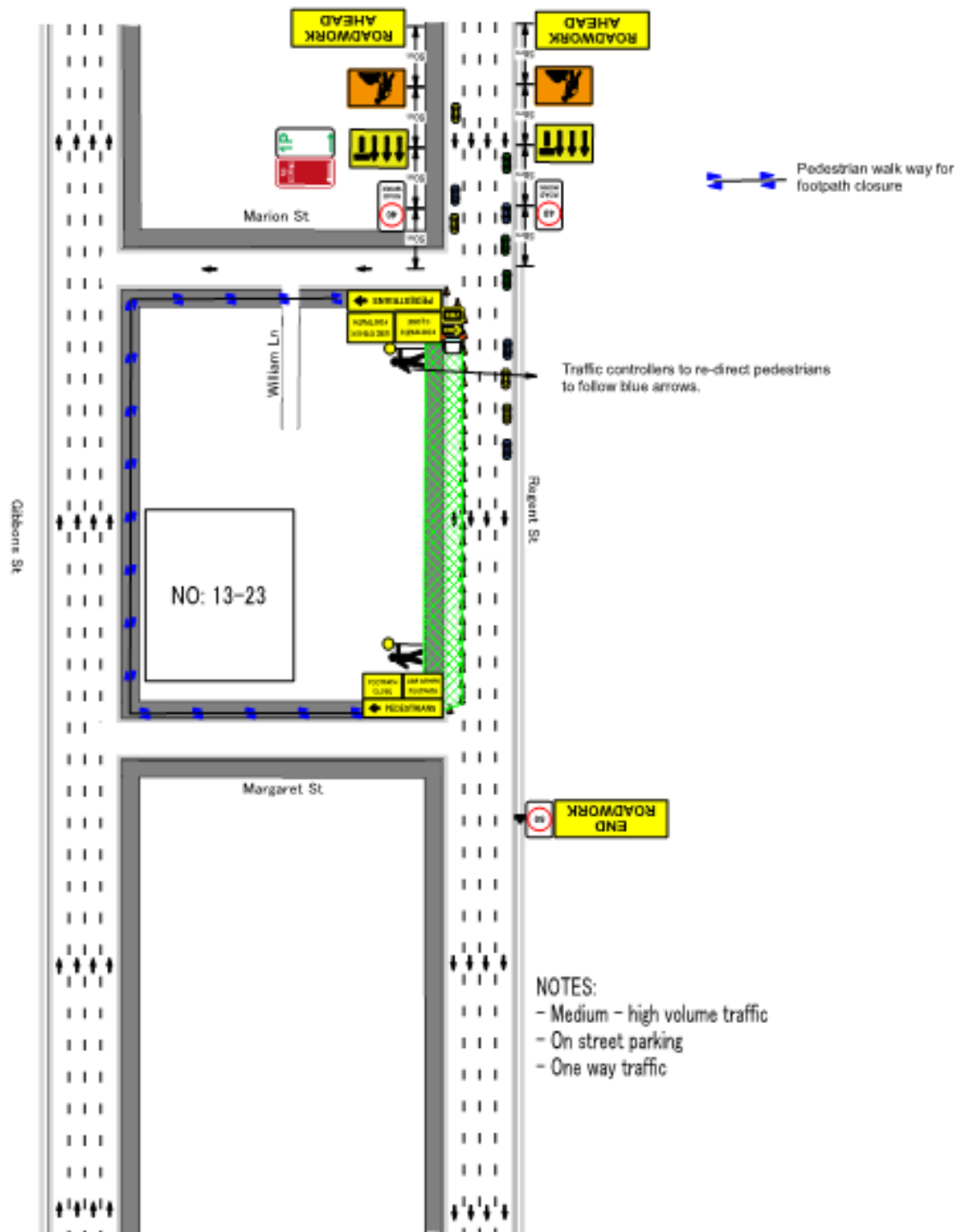

NOTES:

- Medium - high volume traffic
- On street parking
- One way traffic



Plan Designed by:
PAUL PIZZOLATO
PWZTMP: TCT0057346
PH: 0455 135 735
Role: Traffic Planner
Email: traffic@etmholdings.com.au
Signed: Paul Pizzolato
Approved by: Kyle Fieg
PWZTMP: TCT0041658

Paul Pizzolato
Signed: *K. Fieg*

CLIENT: Richard Crookes
PROJECT:
LOCATION: 116 Regent St, Redfern
DATE: 04.04.23
WORK TYPE: Footpath and Lane Closure
PLAN NUMBER: Footpath Closure - 00
MODIFIED BY: BRUNA PINAFFO
PWZTMP: 0052366924 PWZTMP-RIICWD503D

1) This plan is drawn in accordance with Australian Standards and TCAMS
2) This plan is not to scale
3) This plan may only be implemented or modified by persons holding the relevant Licenses to do so
4) Full PPE must be worn by all Traffic Control Officers on worksite
5) ETM Traffic take no responsibility for the implementation of this plan by third party personnel
6) Cone spacing and Taper Length to comply with Table 5.1 and 5.2 of the TCAMS
7) Traffic Controllers must maintain a clear and unobstructed escape route at all times
8) Lead Traffic controller has the authority to cease works if site becomes unsafe
9) The Client and their staff are not authorized to modify this plan without consultation with the author
10) If this plan is to be used in conjunction with RMS PDL, any modifications to the plan must be approved by RMS